

SITE DEVELOPMENT PLANS FOR: St. Andrews Church SLOAN STREET

SLOAN STREET & EDGEWOOD AVENUE - CLEMSON, SC

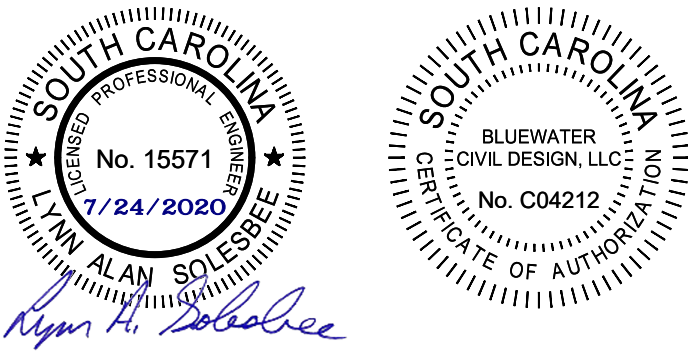

Certificates of Authorization: SC C04212



IMPORTANT NOTE:
ALL NECESSARY INSPECTIONS AND/OR CERTIFICATIONS REQUIRED BY CODES AND/OR UTILITY SERVICE COMPANIES SHALL BE PERFORMED PRIOR TO ANY BUILDING POSSESSION AND THE FINAL CONNECTION OF SERVICES.

IMPORTANT NOTE:
ALL CONSTRUCTION DEBRIS, CLEARING DEBRIS, AND EXCESS TOPSOIL TO BE REMOVED AND HAULED OFF-SITE AT CONTRACTOR'S EXPENSE.

LOCATION MAPS



CONTACT INFORMATION

PLANNING & CODES ADMINISTRATION
 COMPANY: City of Clemson
 ADDRESS: 1250 Tiger Boulevard - Suite 4
 Clemson, SC 29631
 PHONE: 864-653-2050
 CONTACT: Jacob Peabody
 jpeabody@cityofclemson.org

SEDIMENT & EROSION CONTROL
 COMPANY: City of Clemson
 ADDRESS: 1250 Tiger Blvd
 Clemson, SC 29631
 PHONE: 864-624-1126
 CONTACT: Nathan Hinkle, P.E.
 nhinkle@cityofclemson.org

FIRE PREVENTION-FIRE MARSHAL
 COMPANY: City of Clemson - Fire and Life Safety
 ADDRESS: 1250 Tiger Boulevard - Suite 4
 Clemson, SC 29631
 PHONE: 864-653-2050
 CONTACT: John McGarry (Fire Marshal)
 jmcgarry@cityofclemson.org

ENGINEERING
 COMPANY: City of Clemson
 ADDRESS: 1250 Tiger Boulevard - Suite 4
 Clemson, SC 29631
 PHONE: 864-653-2071
 CONTACT: Kent Guthrie, P.E.
 kguthrie@cityofclemson.org

WATER
 COMPANY: City of Clemson
 ADDRESS: 300 Cochran Road
 Clemson, SC 29631
 PHONE: 864-653-2046
 CONTACT: Benjie McGill
 bmcgill@cityofclemson.org

SANITARY SEWER
 COMPANY: City of Clemson
 ADDRESS: 300 Cochran Road
 Clemson, SC 29631
 PHONE: 864-624-1126
 CONTACT: Chris Shivar
 cshivar@cityofclemson.org

ELECTRIC DISTRIBUTION
 COMPANY: Duke Energy
 ADDRESS: 500 Old Greenville Hwy. - Suite 1A
 Clemson, SC 29631
 PHONE: 864-873-4669
 CONTACT: Alan Garrison

NATURAL GAS
 COMPANY: Fort Hill Natural Gas
 ADDRESS: 311 South Pendleton Street
 Easley, SC 29640
 PHONE: 864-859-6375
 CONTACT: Eric Hatton
 eric.hatton@fhnga.com

SHEET INDEX

DESCRIPTION	DWG. NO.
TITLE SHEET	C001
3D LAND SURVEYING SURVEY	3DLS
EXISTING CONDITIONS PLAN	C002
SITE PLAN	C101
GRADING & DRAINAGE PLAN	C201
ROOF DRAIN PLAN	C202
SPOT ELEVATION PLAN	C203
STORM DRAIN PROFILES	C204
UTILITY PLAN	C301
SEWER SEWER MAIN EXTENSION PLAN & PROFILE	C302
PHASE 1 SEDIMENT & EROSION CONTROL PLAN	C401
PHASE 2 SEDIMENT & EROSION CONTROL PLAN	C402
NOTES & DETAILS	C501-C511
LANDSCAPE PLAN	L100

"I have placed my signature and seal on the design documents submitted signifying that I accept responsibility for the design of the system. Further, I certify to the best of my knowledge and belief that the design is consistent with the requirements of Title 48, Chapter 14 of the Code of Laws of SC, 1976 as amended, pursuant to Regulation 72-300 et seq. (if applicable), and in accordance with the terms and conditions of SCRI00000."

I hereby certify that these plans were prepared by me or under my direct supervision and that I am a duly Registered Professional Engineer under the laws of the State of South Carolina and that I am competent to prepare this document.

Lynn A. Solesbee
 LYNN A. SOLESBEE - SCPE# 15571
 7/24/2020
 DATE



Know what's below.
Call before you dig.

OWNER/DEVELOPER
 COMPANY: SAINT ANDREWS CHURCH
 ADDRESS: P.O. BOX 112
 CLEMSON, SC 29633
 PHONE: 864-654-1757
 CONTACT: FATHER DAN MCLELLAN, OFM, PASTOR
 EMAIL: MCLELLAN@SACLEMSON.ORG

CONTRACTOR
 COMPANY: HARPER CONSTRUCTION GROUP, LLC
 ADDRESS: 10703 ANDERSON RD
 EASLEY, SC 29642
 PHONE: 864-272-1527
 CONTACT: AUSTIN ECKLES
 EMAIL: AECKLES@HOGANCONSTRUCTIONGROUP.COM

ARCHITECT
 COMPANY: MPS ARCHITECTURE
 ADDRESS: 400 AUGUSTA STREET, #200
 GREENVILLE, SC 29601
 PHONE: 864-325-1581
 CONTACT: MIKE GOLL
 EMAIL: MGOLL@MCMILLANPAZDANSMITH.COM

CIVIL ENGINEER
 COMPANY: BLUEWATER CIVIL DESIGN, LLC
 ADDRESS: 718 LOWNDES HILL ROAD
 GREENVILLE, SC 29607
 PHONE: 864-735-5453
 CONTACT: LYNN A. SOLESBEE, P.E.
 EMAIL: LYNN@BLUEWATERCIVIL.COM

SURVEYOR
 COMPANY: 3D LAND SURVEYING
 ADDRESS: 10 CENTURY DRIVE, SUITE A
 GREENVILLE, SC 29607
 PHONE: 864-272-0274
 CONTACT: DAVID MODNY, PLS
 EMAIL: INFO@3DLS.NET

DIOCESE OF CHARLESTON
 ST ANDREW'S CATHOLIC CHURCH
 CLEMSON, SOUTH CAROLINA

SHEET ISSUE:

PLAN REVISION	ISSUE DATE	ISSUE COMMENT
A	04.07.2020	Preliminary Site Plan
B	05.18.2020	Preliminary Pricing Plans
C	06.04.2020	CD BRAC SUBMISSION
0	07.16.2020	ISSUE FOR PERMIT
...
...
...
...
...
...
...

PRINCIPAL IN CHARGE: LAS
 PROJECT ENGINEER: ECW
 DRAWN BY: STS

SHEET TITLE:
CIVIL TITLE SHEET

SHEET NO. PROJ. NO.
 2020-029

C001

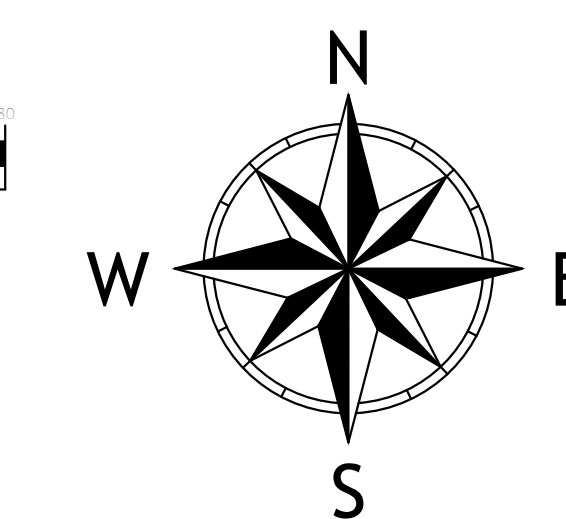
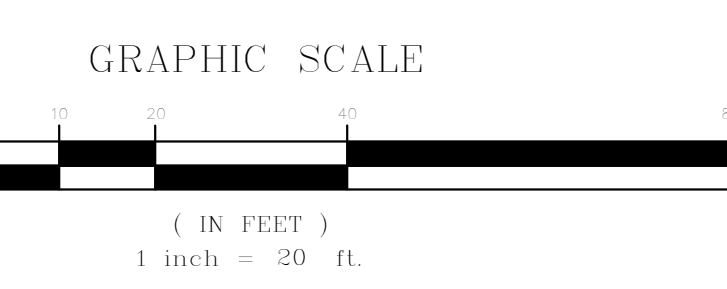

Know what's below.
Call before you dig.



CERTIFICATES OF AUTHORIZATION: SC C04212

SEALS: [Professional Engineer Seal for Ryan H. Schaefer, License No. 15571, State of South Carolina]

SEALS: [Professional Engineer Seal for Ryan H. Schaefer, License No. 15571, State of South Carolina]

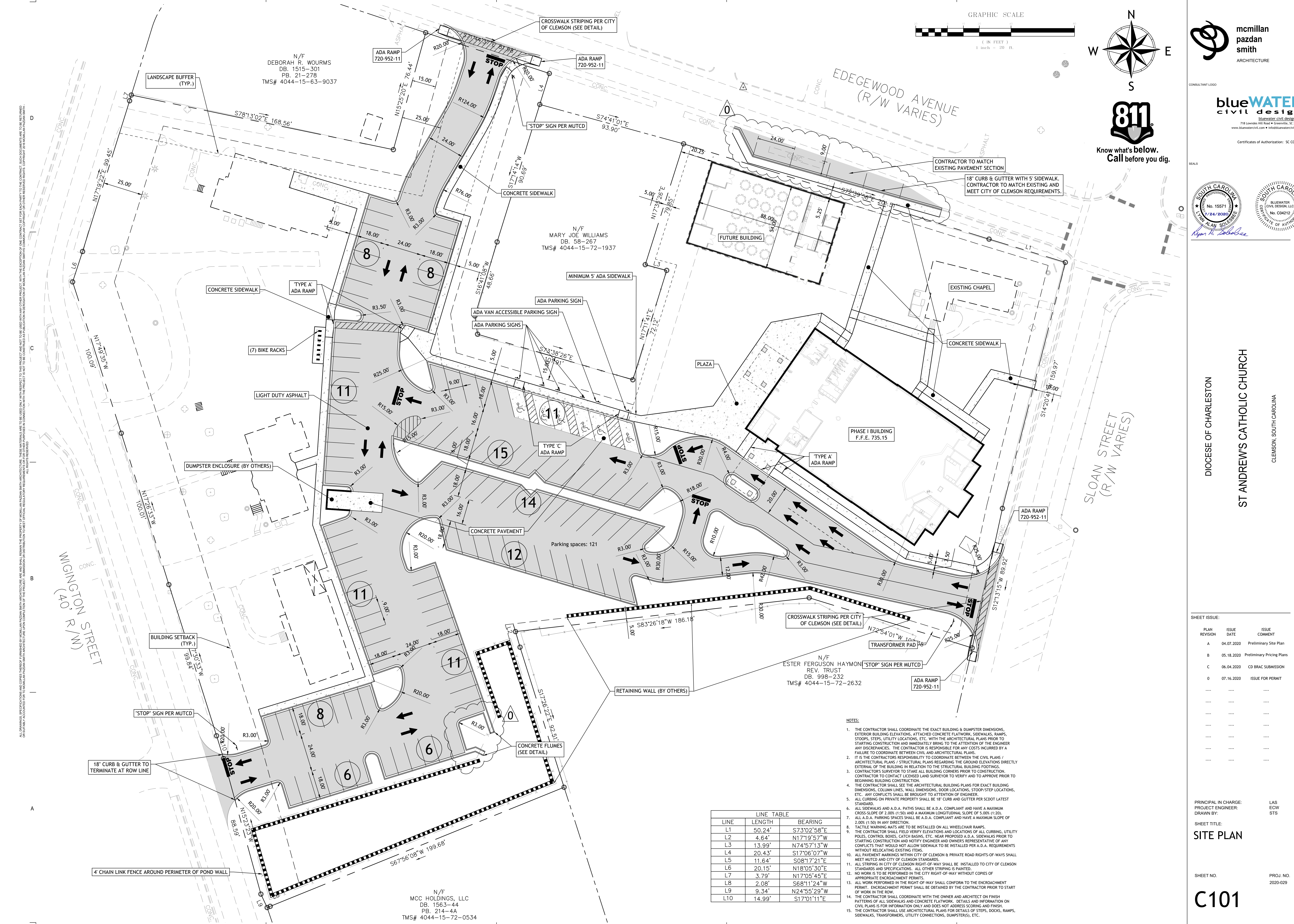

DIocese of Charleston
ST ANDREW'S CATHOLIC CHURCH
CLEMSON, SOUTH CAROLINA

SHEET ISSUE:

PLAN REVISION	ISSUE DATE	ISSUE COMMENT
A	04.07.2020	Preliminary Site Plan
B	05.18.2020	Preliminary Pricing Plans
C	06.04.2020	CD BRAC SUBMISSION
D	07.16.2020	ISSUE FOR PERMIT

PRINCIPAL IN CHARGE: LAS
PROJECT ENGINEER: ECW
DRAWN BY: STS

SHEET TITLE:
SITE PLAN

SHEET NO. **C101** PROJ. NO. 2020-029

LINE TABLE

LINE	LENGTH	BEARING
L1	50.24'	S73°02'58"E
L2	4.64'	N17°19'57"W
L3	13.99'	N74°57'13"W
L4	20.43'	S17°06'07"W
L5	11.64'	S08°17'21"E
L6	20.15'	N18°05'30"E
L7	3.79'	N17°05'45"E
L8	2.08'	S68°11'24"W
L9	9.34'	N24°55'29"W
L10	14.99'	S17°01'11"E

- NOTES:
- THE CONTRACTOR SHALL COORDINATE THE EXACT BUILDING & DUMPSTER DIMENSIONS, EXTERIOR BUILDING ELEVATIONS, ATTACHED CONCRETE FLATWORK, SIDEWALKS, RAMPS, STAIRS, STOPS, UTILITY LOCATIONS, ETC. WITH THE ARCHITECTURAL PLANS PRIOR TO STARTING CONSTRUCTION AND IMMEDIATELY BRING TO THE ATTENTION OF THE ENGINEER ANY DISCREPANCIES. THE CONTRACTOR IS RESPONSIBLE FOR ANY COSTS INCURRED BY A FAILURE TO COORDINATE BETWEEN CIVIL AND ARCHITECTURAL PLANS.
 - IT IS THE CONTRACTORS RESPONSIBILITY TO COORDINATE BETWEEN THE CIVIL PLANS / ARCHITECTURAL PLANS / STRUCTURAL PLANS REGARDING THE GROUND ELEVATIONS DIRECTLY EXTERNAL OF THE BUILDING IN RELATION TO THE STRUCTURAL BUILDING FOOTINGS.
 - CONTRACTOR'S SURVEYOR TO STAKE ALL BUILDING CORNERS PRIOR TO CONSTRUCTION. CONTRACTOR TO CONTACT LICENSED LAND SURVEYOR TO VERIFY AND TO APPROVE PRIOR TO BEGINNING BUILDING CONSTRUCTION.
 - THE CONTRACTOR SHALL SEE THE ARCHITECTURAL BUILDING PLANS FOR EXACT BUILDING DIMENSIONS, COLUMN LINES, WALL DIMENSIONS, DOOR LOCATIONS, STAIR/STEP LOCATIONS, ETC. ANY CONFLICTS SHALL BE BROUGHT TO ATTENTION OF ENGINEER.
 - ALL CURBING ON PRIVATE PROPERTY SHALL BE 18" CURB AND GUTTER PER SCOTD LATEST STANDARD.
 - ALL SIDEWALKS AND A.D.A. PATHS SHALL BE A.D.A. COMPLIANT AND HAVE A MAXIMUM CROSS-SLOPE OF 2.00% (1:50) AND A MAXIMUM LONGITUDINAL SLOPE OF 5.00% (1:20).
 - ALL A.D.A. PARKING SPACES SHALL BE A.D.A. COMPLIANT AND HAVE A MAXIMUM SLOPE OF 2.00% (1:50) IN ANY DIRECTION.
 - TACTILE WARNING MATS ARE TO BE INSTALLED ON ALL WHEELCHAIR RAMPS.
 - THE CONTRACTOR SHALL FIELD VERIFY ELEVATIONS AND LOCATIONS OF ALL CURBING, UTILITY POLES, CONTROL BOXES, CATCH BASINS, ETC. NEAR PROPOSED A.D.A. SIDEWALKS PRIOR TO STARTING CONSTRUCTION AND NOTIFY ENGINEER AND OWNER'S REPRESENTATIVE OF ANY CONFLICTS THAT WOULD NOT ALLOW SIDEWALK TO BE INSTALLED PER A.D.A. REQUIREMENTS WITHOUT RELOCATING EXISTING ITEMS.
 - ALL PAVEMENT MARKINGS WITHIN CITY OF CLEMSON & PRIVATE ROAD RIGHTS-OF-WAYS SHALL MEET MUTCD AND CITY OF CLEMSON STANDARDS.
 - ALL STRIPING IN CITY OF CLEMSON RIGHT-OF-WAY SHALL BE INSTALLED TO CITY OF CLEMSON STANDARDS AND SPECIFICATIONS. ALL OTHER STRIPING IS PAINTED.
 - NO WORK IS TO BE PERFORMED IN THE CITY RIGHT-OF-WAY WITHOUT COPIES OF APPROPRIATE ENCROACHMENT PERMITS.
 - ALL WORK PERFORMED IN THE RIGHT-OF-WAY SHALL CONFORM TO THE ENCROACHMENT PERMIT. ENCROACHMENT PERMIT SHALL BE OBTAINED BY THE CONTRACTOR PRIOR TO START OF WORK IN THE ROW.
 - THE CONTRACTOR SHALL COORDINATE WITH THE OWNER AND ARCHITECT ON FINISH PATTERNS OF ALL SIDEWALKS AND CONCRETE FLATWORK. DETAILS AND INFORMATION ON CIVIL PLANS IS FOR INFORMATION ONLY AND DOES NOT ADDRESS SCORING AND FINISH.
 - THE CONTRACTOR SHALL USE ARCHITECTURAL PLANS FOR DETAILS OF STAIRS, DOCKS, RAMPS, SIDEWALKS, TRANSFORMERS, UTILITY CONNECTIONS, DUMPSTERS, ETC.

ALL DIMENSIONS, SPECIFICATIONS AND NOTES FURNISHED BY MCMILLAN PAZDAN SMITH ARCHITECTURE ARE TO BE USED ONLY WITH RESPECT TO THIS PROJECT AND NOT TO BE USED FOR ANY OTHER PROJECT. THE CONTRACTOR SHALL BE RESPONSIBLE FOR VERIFYING ALL DIMENSIONS AND NOTES. THE CONTRACTOR SHALL BE RESPONSIBLE FOR OBTAINING ALL NECESSARY PERMITS AND APPROVALS. THE CONTRACTOR SHALL BE RESPONSIBLE FOR OBTAINING ALL NECESSARY PERMITS AND APPROVALS. THE CONTRACTOR SHALL BE RESPONSIBLE FOR OBTAINING ALL NECESSARY PERMITS AND APPROVALS. THE CONTRACTOR SHALL BE RESPONSIBLE FOR OBTAINING ALL NECESSARY PERMITS AND APPROVALS.